

CABLE 184 RF: HIROSE U.FL + SMA STRAIGHT BULKHEAD JACK WITH O-RING RATED TO IP67/68 + MULTIPLE CABLE SIZES

SPECIFICATIONS :

- HIROSE U.FL PLUG, P/N: FOR ϕ 1.37MM CABLE: U.FL-LP-088.
FOR ϕ 1.13MM CABLE: U.FL-LP-068.
FOR ϕ 1.32MM DS CABLE: U.FL-LP-066.
FOR ϕ 0.81MM CABLE: U.FL-LP(V)-040.
- COAXIAL CABLE, SEE P/N OPTIONS.
- SMA STRAIGHT BULKHEAD JACK WITH O-RING RATED TO IP67/68, P/N: RFCT-SMA002-F78.

USAGE PRECAUTIONS: CABLES USING 'MICRO' COAX ARE DELICATE:
 (i) HANDLE WITH CARE.
 (ii) DO NOT TWIST; APPLY EXCESSIVE FORCES OR SHARP BENDS TO THE CABLE. DO NOT FORCEFULLY DEFORM WIRES.
 (iii) CONSULT CONNECTOR MANUFACTURER'S DATASHEETS FOR DETAILED NOTES ON HANDLING INSTRUCTIONS.

ENVIRONMENTAL:

- A. BULKHEAD MOUNTED CONNECTOR (RFCT-SMA002-F78) TESTED TO THE FOLLOWING SPECIFICATION:
- IP6X - DUST TIGHT - NO PARTICLE INGRESS.
 - IPX7 WATERPROOF FOR 30 MINUTES UP TO 1 METER UNDERWATER.
 - IPX8 WATERPROOF FOR 48 HOURS AT 1 METER UNDERWATER.
 - IPX8 WATERPROOF FOR 12 HOURS AT 5 METERS UNDERWATER.
 - PRESSURE TEST - 1 BAR FOR 10 SECONDS.

NOTES:

- THE ORIENTATION OF CONNECTORS ON DRAWING IS FOR REFERENCE ONLY, IF THE ORDER IS LEFT BLANK THE CONNECTOR WILL NOT HAVE FIXED ORIENTATION.
- FIXED ORIENTATION IS SUGGESTED FOR CABLE LENGTH 25MM TO 100MM. PLEASE SPECIFY THE FIXED ORIENTATIONS FROM THE ORDER CODE (F1, F2, ETC)
- CONTACT GRADCONN IF THE ORIENTATION YOU REQUIRE IS NOT SHOWN.
- WORKING FREQUENCY RANGE: DC-3GHz.
- OPERATING TEMPERATURE: -40°C TO +85°C.
- IMPEDANCE: 50 OHM.

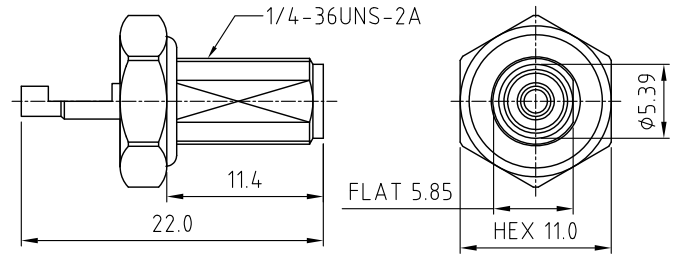
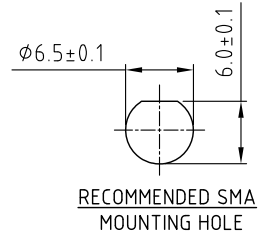
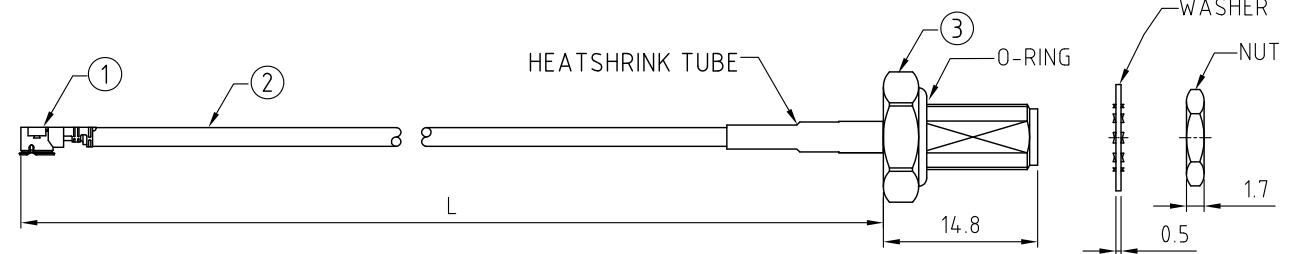

HOW TO ORDER

CABLE 184 RF - X X X - X X - X - X - X

"L" LENGTH IN MM:
 eg: 100MM = 100
 (MIN. 050-MAX.400)
 STANDARD = 100, 150, 200
 Tolerance: 50-200mm: ±5mm.
 201-400mm: ±7mm.

HEAT SHRINK TUBE COLOR OPTIONS:
 BLANK = BLACK (STANDARD)
 B = BLUE

CABLE SIZE OPTIONS:
 1 = ϕ 1.37MM CABLE, COLOR: BLACK.
 2 = ϕ 1.13MM CABLE, COLOR: GRAY.
 3 = ϕ 1.32MM DS CABLE, COLOR: GRAY
 4 = ϕ 0.81MM CABLE, COLOR: GRAY

WASHER AND NUT OPTIONS:
 BLANK = SEPARATELY PACKED (STANDARD)
 A = ALL ASSEMBLED WITH CONNECTOR

ORIENTATION OPTIONS:
 BLANK = DOES NOT HAVE A FIXED ORIENTATION
 F1 = U.FL CONNECTION DOWN (L=25-200MM)
 F2 = U.FL CONNECTION UP (L=25-200MM)
 (SEE NOTES 1, 2, 3 AND DIAGRAMS FOR MORE INFORMATION)

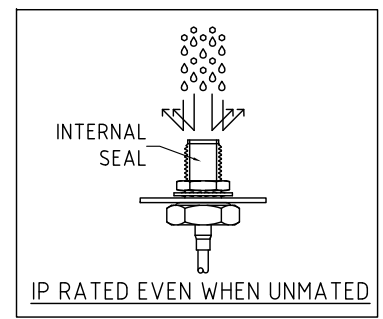
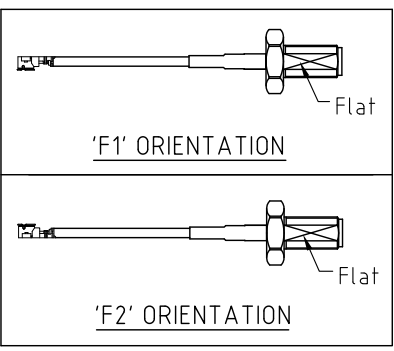

REV. DATE & DRN
10. 28/07/14 - NYW RELEASE
11. 23/07/15 - NYW PART NUMBER.
12. UPDATE SMA PART NUMBER.
13. ADD IP67/68 RATING INFO.
14. 16/06/16 - NYW
ADD 1.13 CABLE OPTION.
15. 26/06/17 - NYW
ADD 1.32DS CABLE OPTION.
16. 03/07/21 - NYW
ADD HEAT SHRINK TUBE
17. 03/07/21 - NYW
AMEND U.FL P/N FOR 1.32DS
CABLE.
ADD NOTES 3 & 6.
18. 28/07/23 - NYW
ADD CABLE SIZE OPTION 4.
19. 09/07/24 - CC
ADD IP RATING VIEW

Scale: NTS	THIRD ANGLE	Unstated Tolerances:
Drawn: CC		.X ±0.2
App'd: XXX	Title CABLE ASSEMBLY	.XX ±0.2
Date: 3 MAR. '24	Revision: 1.8	.XXX ±0.2
	Unit: mm	ANGLES ±5



IP Rated RF Products
 www.gradconn.com
 THIS DRAWING IS CONFIDENTIAL AND MUST NOT BE COPIED OR DISCLOSED WITHOUT WRITTEN CONSENT

Type: Cable 184 RF
CABLE 184 RF
Drawing Number:
Sheet 1 of 1
Drawing © E and O E